



# LDX-T Series

6, 12 and 24 Volts  
T-Bar Units

## Fully recessed units for T-Bar mounting in suspended ceilings

The LDX-T Series battery units are designed for T-bar ceiling grid installation. This slim-line, unobtrusive unit is ideally suited for any commercial location where there is limited wall space and where the greater directional flexibility of ceiling-mounted heads is needed to provide greater light distribution.

### Features

- Rugged steel cabinet with corrosion-resistant undercoating. Fixtures, cabinet and mounting brackets are available in factory white, polar white and black
- Battery and charger are concealed above the ceiling level in the unit cabinet
- Removable panel provides easy access to battery and circuitry
- Test switch and LED indicators are mounted on the visible bottom panel
- Units mount quickly and easily in standard 2' x 2' or 2' x 4' grids without any additional hardware
- Solid-state pulse-type charger – current-limited, temperature-compensated, short-circuit proof and reverse-polarity protected.
- Unit comes standard with electronic lockout and brownout circuits
- Sealed dust-proof transfer relay, test switch and LED indicator lights
- Long-life, maintenance-free lead acid battery – operates in extreme temperature ranges
- Wide range of lamp heads available – consult Ordering Information for complete list. Emergency lighting heads requiring no tools to adjust or aim.
- Standard 120/347Vac input voltage
- NEXUS® compatible (for more information on NEXUS®, please consult factory.)
- CSA C22.2 No. 141 certified



NEXUS



READY-LITE™



Project/Location:

Date:

Contractor:

Prepared by:

# LDX-T Series

## Typical Specification



Supply and install a complete emergency lighting system as described herein and shown on the drawings.

The READY-LITE™ Smart Diagnostic micro-controller board shall supply the rated load for a minimum of a 1/2 hour to 87.5% of the rated battery voltage. The unit shall be rated 120V or 347V, 60 Hz and be CSA listed. The unit shall have an output of \_\_\_\_\_ volts. The charger shall be fully computer tested and its charge voltage factory set to ± 1% tolerance. Chargers with field-adjusted potentiometers are not acceptable. A pulse-type charger shall be employed to promote long battery life and reduce the potential for grid corrosion. The charger shall provide a continuous high charge to recharge the battery, when the battery is at full capacity, the charger will shut-off. Periodically the charger shall provide a pulse of energy to keep the battery topped off. The charger shall be current limited, temperature compensated, short-circuit proof and reverse polarity protected. The unit shall be furnished with an electronic lockout circuit, which will

connect the battery when the AC circuit is activated, and an electronic brownout circuit, which will activate the emergency lights when utility power dips below 75% of nominal voltage. A low voltage battery protection circuit shall be provided and will disconnect the load and circuitry from the fused output circuit when the battery reaches the end of discharge. The unit shall self-test for 1 minute every 30 days, 10 minutes on the 6th month and 30 minutes every 12 months. The unit shall be capable of full recharge in compliance with CSA specifications. The unit shall be furnished with sealed dust tight relay, a test switch and diagnostic LED indicator lights to continuously monitor the status of the unit: Battery Failure, Battery Disconnected, Charger Failure, Lamp Failure, Service Alarm, AC "ON", Charger High Rate. The unit shall come complete with tool-less emergency lighting heads requiring no tools to adjust or aim.

The unit shall be READY-LITE™ Model \_\_\_\_\_.

## Dimensions

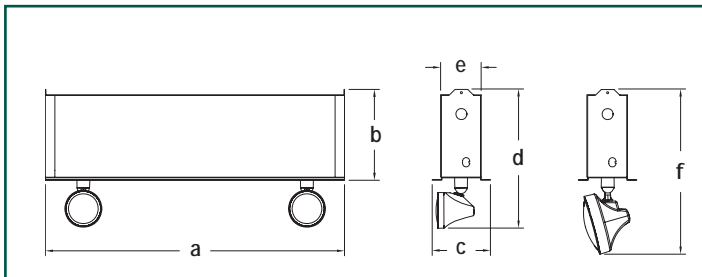

Dim.	Cabinet	
	Large Cabinet (L)	Small Cabinet (S)
a	23¾ in. [60.3 cm]	23¾ in. [60.3 cm]
b	7¼ in. [18.3 cm]	7¼ in. [18.3 cm]
c	7¼ in. [18.0 cm]	4¾ in. [11.8 cm]
d	11 in. [28.1 cm]	11 in. [28.1 cm]
e	5½ in. [14.4 cm]	3¼ in. [8.2 cm]
f	13½ in. [33.3 cm]	13½ in. [33.3 cm]

## Ordering Information

Series	Capacity/ Cabinet Size	Special Option	# of Heads	Head Style / Lamp Wattage	Colour	A.C. Voltage	Options
LDX6= 6 volts	-36T= 36 watts [ S ]*	Blank= standard AD= auto-diagnostic ADN= auto-diagnostic non-audible	Blank= no head 1= one head 2= two heads 3= three heads	RT9= mini tungsten, 6V, 12V, 24V - 9 watts, wedge base	Blank= factory white BK= black	Blank= 120/347Vac input U347= 347 Vac input U277= 277Vac input U240= 240Vac input U220= 220/50Hz Vac input	A= ammeter CT= cabtire D5= time delay D6= 6cct. fuse panel IT= AC terminal block LB= light activated test switch LD= lamp disconnect NEX= NEXUS system interface* (for 6V & 12V units only) OT= output terminal block R1= remote test receiver TL= twist lock plug V= voltmeter
	-72T= 72 watts [ S ]*			RT18= mini tungsten, 12V, 24V - 18 watts, wedge base			
	-108T= 108 watts [ S ]*			RQ8= mini halogen, 6V, 12V - 8 watts, quartz bi-pin			
	-180T= 180 watts [ L ]*			RQ12= mini halogen, 6V, 12V - 12 watts, quartz bi-pin			
EXAMPLE : LDX6-108TAD2RQ8				LT9= large tungsten , 6V, 12V, 24V - 9 watts, wedge base			
LDX12= 12 volts	-36T= 36 watts [ S ]*			LT18= large tungsten, 12V, 24V - 18 watts, wedge base			
	-72T= 72 watts [ S ]*			LT25= large tungsten, 6V, 12V, 24V - 25 watts, DCB			
	-100T= 100 watts [ S ]*			LQ8= large halogen, 6V, 12V - 8 watts, quartz bi-pin			
	-144T= 144 watts [ S ]*			LQ12= large halogen, 6V, 12V - 12 watts, quartz bi-pin			
EXAMPLE : LDX12-100TAD2RM12				LQ20= large halogen, 6V, 12V, 24V - 20watts, quartz bi-pin			
LDX24= 24 volts	-144T= 144 watts [ L ]*			LQ55= large halogen, 12V - 55 watts, H3			
	-288T= 288 watts [ L ]*			LQ70= large halogen, 24V - 70 watts, H3			
EXAMPLE : LDX24-144TAD2RL150MD				RM6= mini halogen, 6V - 6 watts, MR16			
				RM10= mini halogen, 6V - 10 watts, MR16			
				RM12= mini halogen, 12V - 12 watts, MR16			
				RM20= mini halogen, 12V, 24V - 20 watts, MR16			
				LS9= large tungsten, 6V, 12V - 9 watts, sealed beam			
				LS18= large tungsten, 6V, 12V - 18 watts, sealed beam			
				LS25= large tungsten, 6V, 12V, - 25 watts, sealed beam			
				LH8= large halogen, 6V, 12V - 8 watts, quartz sealed beam			
				LH12= large halogen, 6V, 12V - 12 watts, quartz sealed beam			
				LH20= large halogen, 6V - 20 watts, quartz sealed beam			
				RL150MA= mini deco halogen, 12V - 20 watts, MR16*			
				RL150MB= mini deco halogen, 12V - 35 watts, MR16*			
				RL150MC= mini deco halogen, 12V - 50 watts, MR16			
				RL150MD= mini deco halogen, 24V - 20 watts, MR16*			
				RL150ME= mini deco halogen, 24V - 35 watts, MR16*			
				RL150MF= mini deco halogen, 24V - 50 watts, MR16*			
				*Supplied with polar white or black cabinet only.			

\* Cabinet size is not part of ordering information.